

ITEM	PART #	QTY.	DESCRIPTION
1	KCN-037	1	CYLINDER CUTOFF CAP
2	KCN-031	1	DISTANCE RING FOR 5MM PISTON SPRING
3	KCN-029	1	PISTON SPRING
4	KCN-038	1	GUIDE PISTON , HARD CHROME STAINLESS STEEL
5	KCN-019	1	GRACO U-RING
6	KCN-042	1	NUT, ON PISTON GUIDE, STAINLESS STEEL
7	KCN-051	1	GASKET, COPPER, ON GUIDE VALVE BETWEEN 22
8	KCN-022	1	O-RING, FOR CENTER LEVER ARM
9	KCN-026	1	CHECK SCREW FOR NEEDLE MS-3
10	KCN-032	1	GUN BODY, STAINLESS STEEL
11	KCN-021	1	GASKET, NYLON BETWEEN BODY AND HEAD
12	-	-	-
13	KCN-055	1	STAINLESS STEEL SCREW TO FASTEN HEAD TO GUN
14	KCN-047	1	NEEDLE PACKING NUT
15	KCN-023	1	GASKET, NYLON, ON GUIDE BETWEEN 14 & 16
16	KCN-039	1	CHECK RING FOR PISTON SPRING
17	KCN-040	1	CHECK NUT
18	KCN-052	2	COPPER GASKET, BETWEEN 19 & BODY
19	KCN-036	1	12MM NUT FOR CENTER LEVER ARM
20	KCN-044	1	CENTER NEEDLE SPRING
21	KCN-034	1	NEEDLE FOR FIXING SOCKET W/ SCREW

ITEM	PART #	QTY.	DESCRIPTION
22	KCN-033	1	LEVER ARM
23	KCN-054	1	GUIDE FOR GUN HEAD
24	KCN-017	-	NEEDLE PACKING, COMPLETE
25	KCN-020	4	7MM DIA FILTER, NETTING FILTER
26	KCN-053	1	NUT SECURE, FILTERS
27	KCN-028	1	AIR INTAKE CONNECTION, ON VALVE SIDE
28	KCN-030	1	VALVE SPRING
29	KCN-043	1	10MM DIA STAINLESS STEEL VALVE BALL
30	KCN-025	1	O-RING FOR VALVE BALL 34
31	KCN-050	2	CAP
32	KCN-027	1	AIR INTAKE CONNECTION, PISTON SIDE
33	KCN-024	1	NYLON RING
34	KCN-035	1	VALVE BODY
35	KCN-018	1	O- RING PIN
36	KCN-041	2	34MM LONG GUIDE PIN
37	KCN-046	1	AIR NOZZLE BASIC FITTING NUT
38	KCN-056	1	SNAP RING FOR AIR NOZZLE
39	KCN-049	1	NUT, FIXING FOR EXTERIOR NOZZLE
40	-	-	-
41	KCN-064	1	AIR NOZZLE, BASIC, 8.9-14
42	KCN-065	1	MATERIAL NOZZLE, 6.8

ITEM	PART #	QTY.	DESCRIPTION
43A	KCN-074	1	NOZZLE, EXTERIOR, 42-10-25
43B	KCN-013	1	NOZZLE, EXTERIOR, 25-10-18
43C	KCN-066	1	NOZZLE, EXTERIOR, 41-14-25
44	KCN-048	1	KEY TO TIGHTEN NEEDLE PACKING
45	KCN-H01	1	GUN HANGER
46	KCN-B01	1	BOOT, NYLON, PROTECTOR
47	F-03750694-SS	1	NIPPLE HEX, SS, 3/8" X 3/8"
52	KCN-063-1	1	NEEDLE TIP
53	KCN-063-2	1	JAM NUT NEEDLE TIP
60	120-64	2	ADAPTER
61	F-01250825-SS	1	PLUG, STAINLESS STEEL (SEE OPTION 67)
62	KCN-099	1	BOLT GUN HOLDER
63	40384	1	LOCK WASHER GUN HANGER
64	40358	1	FLAT WASHER GUN HANGER
65	26036	1	SET SCREW GUN HANGER
66	KCN-202	1	HEAD OF GUN
-	KCN-20-RBK	-	SEE PAGE 2 OR ITEMS MARKED WITH (*)
-	KCN-063	1	NEEDLE ASSEMBLY ITEMS MARKED WITH (**)
67	KCN-S01	-	SHROUD PAINT
68	KCN-FDF	1	VALVE & FITTINGS FLUSH ON FLY
69	KCN-G01	1	GUARD TIP, NAUTILUS 15 & 20 GUN

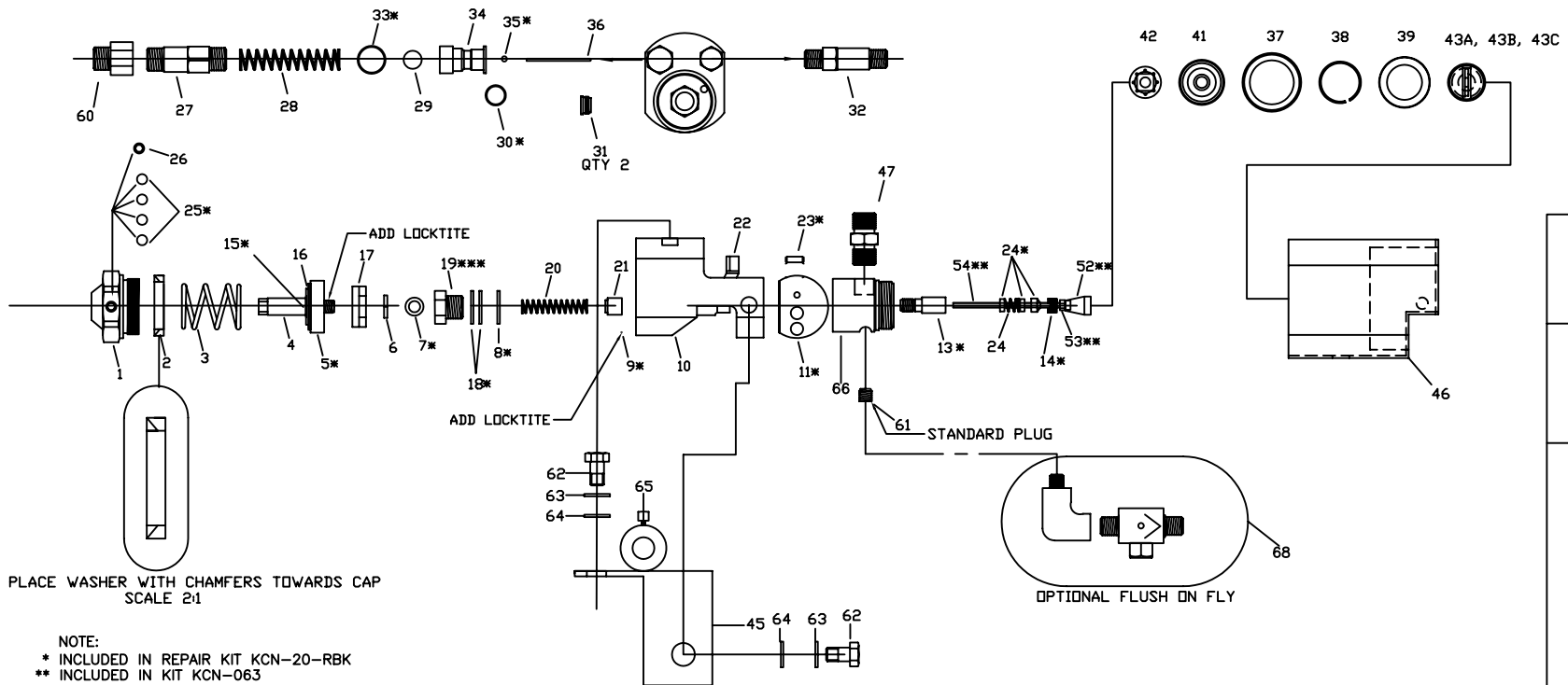

TOLERANCES UNLESS OTHERWISE SPECIFIED:
Angular $\pm 2^\circ$
Fractional $\pm 1/16"$
.X = ± 1
.XX = ± 0.1
.XXX = ± 0.005
.XXXX = ± 0.0015

CONFIDENTIAL
THIS DOCUMENT, INCLUDING ALL INFORMATION HEREIN, IS THE EXCLUSIVE AND CONFIDENTIAL PROPERTY OF ERNEST INDUSTRIES. THEREFORE THIS DOCUMENT IS NOT TO BE COPIED, REPRODUCED, OR DELIVERED TO OTHERS WITHOUT THE EXPRESS WRITTEN PERMISSION OF ERNEST INDUSTRIES.

Kelly-Creswell
1221 Groop Rd.
Springfield, OH 45504
937-325-3978
KC Since 1937

DRAWN BY
CDW
APPROVED BY
DATE
1-18-11
DATE APPROVED

TITLE:
NAUTILUS N20 STRIPING GUN
DESCRIPTION:
STRIPING GUN
DWG NO./PART NO.
KCN-N20
SCALE:
N/A
SIZE:
A
PAGE #:
1-2
REV:
B



KCN-051
GASKET, COOPER,
QTY: 1

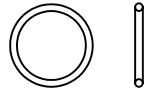

KCN-022
O-RING, FOR CENTER LEVER ARM
QTY: 1



KCN-025
O- RING FOR VALVE BALL 34
QTY: 1



KCN-047
NEEDLE PACKING NUT
QTY: 1



KCN-018
O-RING, PIN
QTY: 1

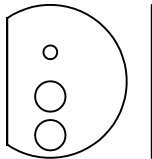

KCN-021
GASKET, NYLON
QTY: 1

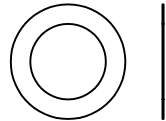

KCN-024
NYLON RING
QTY: 1

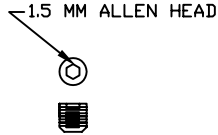

KCN-026
CHECK SCREW FOR NEEDLE MS-3
SCALE 2:1
QTY: 1

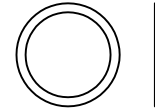

KCN-052
COPPER GASKET,
QTY: 2



KCN-054
GUIDE FOR GUN HEAD
QTY: 1

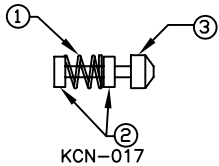

KCN-017
NEEDLE PACKING, COMPLETE, TEFLON GRAPHITE
NEEDLE SHOWN FOR PLACEMENT OF PARTS



KCN-017-1
QTY: 1



KCN-017-2
QTY: 2



KCN-017-3
QTY: 1

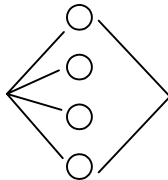

KCN-020
7MM DIA FILTER, NETTING FILTER
QTY: 4

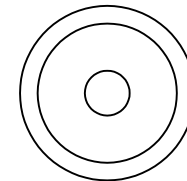

KCN-019
GRACO U-RING
QTY: 1

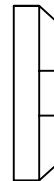

KCN-023
GASKET, NYLON
QTY: 1

TOLERANCES UNLESS OTHERWISE SPECIFIED:
Angular $\pm 2^\circ$
Fractional $\pm 1/16"$
.X = ± 1
.XX = ± 0.1
.XXX = ± 0.005
.XXXX = ± 0.0015

CONFIDENTIAL
THIS DOCUMENT, INCLUDING ALL INFORMATION HEREIN, IS THE EXCLUSIVE AND CONFIDENTIAL PROPERTY OF ERNEST INDUSTRIES. THEREFORE THIS DOCUMENT IS NOT TO BE COPIED, REPRODUCED, OR DELIVERED TO OTHERS WITHOUT THE EXPRESS WRITTEN PERMISSION OF ERNEST INDUSTRIES.

Kelly-Creswell
1221 Groop Rd.
Springfield, OH 45504
937-325-3978



Since 1937
DRAWN BY CDW
APPROVED BY
DATE 5-28-10
DATE APPROVED

TITLE:
NAUTILUS N20 STRIPING GUN

DESCRIPTION:
STRIPING GUN

DWG NO./PART NO.
KCN-20
SCALE: N/A
SIZE: A
PAGE #: 2-2
REV: A