

NOTE:

1. (*) INCLUDED IN NEEDLE REPAIR KIT PART NUMBER KC-153

2. (***) INCLUDED IN TIP REPAIR KIT PART NUMBER KC-154

TYPICAL PLUMBING ON BEAD GUNS

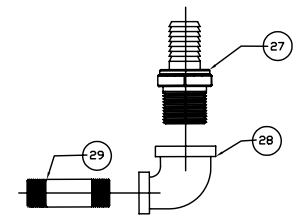

ITEM	QTY	PART NO	DESCRIPTION
1	1	KC-593B	BEAD GUN
1A	1	KC-119	FRAME
*	2	KC-110	NEEDLE PACKING (SET OF 2)
3	1	KC-109	PACKING NUT
4	1	KC-111	PACKING GLAND COVER
5	1	KC-113	TRIGGER PIN
*	6	KC-106	NEEDLE
7	1	KC-104	SPRING GUIDE
8	1	KC-102	LOCKING NUT
9	1	KC-101	ADJUSTING SCREW
*	10	KC-103	SPRING, NEEDLE
11	1	KC-105	NEEDLE ADJUSTMENT STOP
12	1	KC-114	SPRING COTTER PIN
13	1	KC-112	TRIGGER
14	1	KC-115	DIAPHRAGM PLATE & PIN
15A	1	H-2008	NIPPLE, BRASS, 1/4 X 1/4 NPT
15B	1	KQH07-35S	PUSH LOCK FITTING, 1/4T X 1/4P
16	8	KC-118	DIAPHRAGM SCREWS
*	17	KC-116	DIAPHRAGM
18	1	MB-47	LOCATING PIN
*	19	AV-1	GASKET, FLUID TIP
20	1	KC-117	DIAPHRAGM COVER
**	21	KC-502	BEAD DEFLECTOR PLATE (FIN)
**	22	AV-11	RETAINING NUT, KNURLED
**	23	KC-501	BEAD NOZZLE W/ SET SCREW
*	24	WV-1115-SS	FLUID TIP 11/64
25	1	WV-94	ADAPTER, FLUID TIP
26	1	F-02500820	PLUG SQ HD 1/4" NPT
27	1	125 HBL-12-12	BARB, 3/4" NPT X 3/4" BRASS
28	1	F-07500590-BK	ELBOW, 90 DEG. 3/4" X 3/8" REDUC.
29	1	F-03750630-BK	NIPPLE, 3/8" NPT X 2"

TOLERANCES UNLESS OTHERWISE SPECIFIED:
 Angular ±2°
 Fractional ±1/16"
 .X= ±.1
 .XX=±.01
 .XXX=±.005
 .XXXX=±.0015

CONFIDENTIAL
 THIS DOCUMENT, INCLUDING ALL INFORMATION HEREIN, IS THE EXCLUSIVE AND CONFIDENTIAL PROPERTY OF ERNEST INDUSTRIES. THEREFORE THIS DOCUMENT IS NOT TO BE COPIED, REPRODUCED, OR DELIVERED TO OTHERS WITHOUT THE EXPRESS WRITTEN PERMISSION OF ERNEST INDUSTRIES.

Kelly-Creswell
 1221 Groop Rd.
 Springfield, OH 45504
 937-325-3978
 Since 1937

DRAWN BY
 CDW
 APPROVED BY

DATE
 5-25-10
 DATE APPROVED

TITLE:
 KC-593B
 DESCRIPTION:
 STRIPING GUN B

DWG NO./PART NO.
 KC-593B
 SCALE: N/A
 SIZE: A
 PAGE #: 1-2
 REV: A

NEEDLE REPAIR KIT PART
NUMBER KC-153



KC-110
NEEDLE PACKING (SET OF 2)
QTY-1

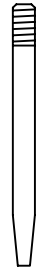

KC-106
NEEDLE, STAINLESS STEEL
QTY-1



KC-103
SPRING, NEEDLE
QTY-1



KC-116
DIAPHRAGM
QTY-1



AV-1
GASKET FLUID TIP
QTY-1



WV-1115-SS
FLUID TIP 11/64
QTY-1

TIP REPAIR KIT PART
NUMBER KC-154



KC-502
BEAD DEFLECTOR PLATE (FIN)
QTY-1



AV-11
RETAINING NUT, KNURLED
QTY-1

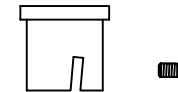

KC-501
BEAD NOZZLE W/ SET SCREW
QTY-1

TOLERANCES UNLESS
OTHERWISE SPECIFIED:
Angular $\pm 2^\circ$
Fractional $\pm 1/16'$
.X = ± 1
.XX = ± 0.1
.XXX = ± 0.005
.XXXX = ± 0.0015

CONFIDENTIAL
THIS DOCUMENT, INCLUDING
ALL INFORMATION HEREIN,
IS THE EXCLUSIVE AND
CONFIDENTIAL PROPERTY
OF ERNEST INDUSTRIES.
THEREFORE THIS DOCUMENT
IS NOT TO BE COPIED,
REPRODUCED, OR
DELIVERED TO OTHERS
WITHOUT THE EXPRESS
WRITTEN PERMISSION OF
ERNEST INDUSTRIES.

Kelly-Creswell
1221 Groop Rd.
Springfield, OH 45504
937-325-3978



DRAWN BY
CDW

DATE
7-14-10

APPROVED BY

DATE APPROVED

TITLE:

KC-593B

DESCRIPTION:

KC-153/KC-154 REBUILD KITS

DWG NO./PART NO.

KC-593B

SCALE:
N/A

SIZE:
A

PAGE #:
2-2

REV:
A